



## PRODUCT SPECIFICATION

### Cambridge roller

#### Fields of application:

- Cambridge rollers are especially suitable for additional pre-sowing soil processing, restoration of soil capillarity, crumbling of clods and surface levelling.
- They are also suitable for the soil processing after sowing - more uniform seed emergence and acceleration of vegetation.

#### Technical data:

- Material quality: EN-GJL-200 (grey cast iron),
- upon request in painted design,
- sizes:

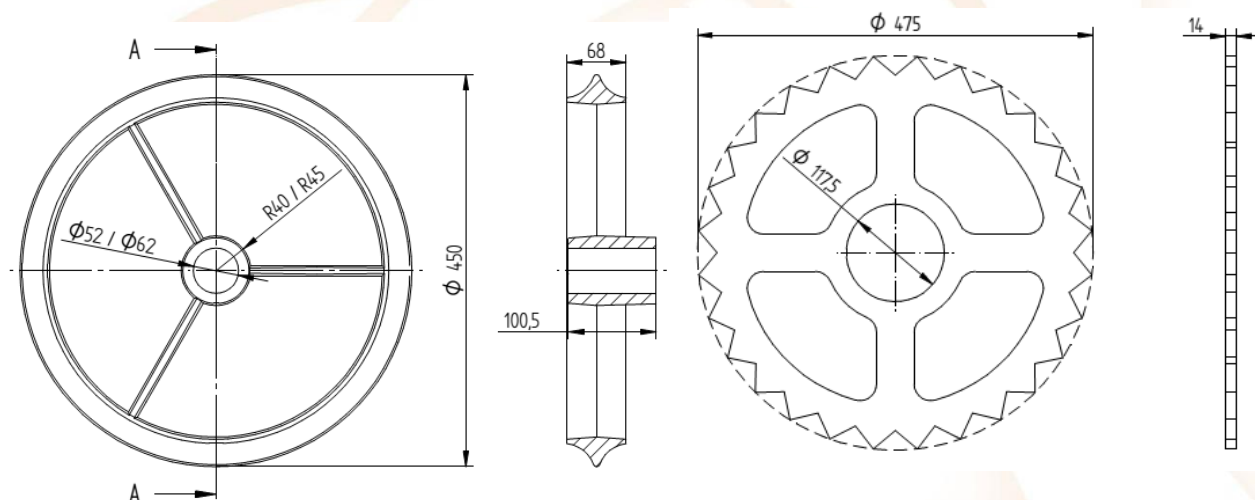

#### Mohácsi Vasöntöde Kft.

H-7700 Mohács, Kossuth L. u. 53-55. ■ Tel: (+36) 69 322 733 ■ Fax: (+36) 69 311 433 ■ E-mail: info@vasontode.hu

Égyszám: 0209061982 ■ Adószám 11006536-2-02 ■ Bank: 10400779-49485050-48481000 ■ IBAN HU80 1040 0779 4948 5050 4848 1000 ■ SWIFT: OKHBHUHB



ISO 9001  
QM HU 1 17 383 12  
www.ecomcert.org

**MOHÁCSI VASÖNTÖDE**

Since 1894

[www.vasontode.hu](http://www.vasontode.hu)



**Mohácsi Vasöntöde Kft.**

H-7700 Mohács, Kossuth L. u. 53-55. • Tel: (+36) 69 322 733 • Fax: (+36) 69 311 433 • E-mail: [info@vasontode.hu](mailto:info@vasontode.hu)

Égjegyzékszám: 0209061982 • Adószám 11006536-2-02 • Bank: 10400779-49485050-48481000 • IBAN HU80 1040 0779 4948 5050 4848 1000 • SWIFT: OKHBHUHB